

# Readers & Credentials

**CR-KEYPAD**  
Quick Guide

## Components

Before using the device, check the device model and ensure that the shipped box includes the following items:

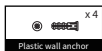
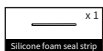

## Product Overview

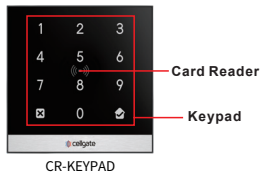

## Preparation

### Tools Needed

(not included in shipped box)

- Phillips Screwdriver
- Electric Drill

## Voltage and Current Specifications

Use 12V DC 1A power supply with 18 gauge wiring to power the device.

## Installation Guidelines

- Install the device on a flat surface.
- Do not use or place the device near heating objects.

 **Warning!**

To ensure your safety, avoid touching the power cord, power adapter, and device with wet hands, bending or pulling the power cord, damaging any components, and only use the qualified power adapter and power cord.

 **Caution**

- Do not knock device with hard objects.
- Do not press down hard on the device screen.
- Do not expose device to chemical products, such as alcohol, acid liquid, disinfectants, etc.
- To prevent the device installation from loosening, ensure accurate sizes and depths of screw holes.
- To clean the device, wipe with a moist cloth, then wipe with a dry cloth.

## Installation

### Step 1: Bracket Installation

#### Wall-Mounting Installation

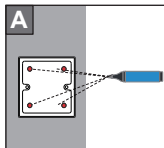

Mark the positions of the four holes of the junction box.

Note: The junction box should be at least 43 inches (1100 mm) above the ground.

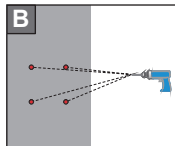

Drill the four marked holes using a 1/4" (6 mm) drill bit. The drilled holes should be 30 mm.

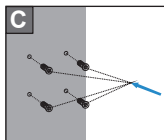

Insert the plastic wall anchors into the drilled holes.

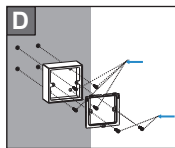

Fix the junction box onto the wall using four ST4x20 Phillips screws.

Fix the cable-locking plate onto the junction box using two M4x30 Phillips screws.

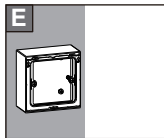

Junction box installation is complete.

#### Wire Descriptions

<b>Red</b>	12V DC+ Power
<b>Black</b>	Power Ground
<b>Gray</b>	Wiegand Ground
<b>Green</b>	Wiegand Data 0
<b>White</b>	Wiegand Data 1

### Flush-Mounting Installation

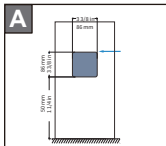

Cut a hole with dimensions 3 and 3/8 inches high, 3 and 3/8 inches wide, and 1 and 1/4 inches deep. Lead a cable from the square hole into the junction box.

Note: Skip this step if the junction box has already been embedded into the wall.

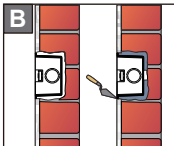

Fill the gap between the hole and the junction box with concrete or other non-corrosive construction adhesive.

Wait until the concrete or the adhesive hardens before proceeding to the next step.

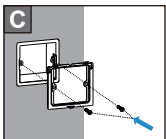

Fix the cable-locking plate onto the junction box using two M4x30 Phillips screws.

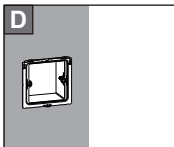

The junction box installation is complete.

### Step 2: Device Mounting

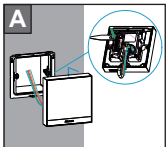

Use a pry bar to press down the terminal slot while inserting the wires as needed.

Note: Ensure each wire is properly arranged.

Make all cables go through the groove of the cable-locking plate. Hang the device onto the wall-mounting bracket.

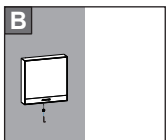

Push the device down against the corresponding hook hanger and tighten the device with a M3x4 headless screw using an Allen wrench.

## Warranty

CellGate does not cover intentional mechanical damage or destruction caused by improper installation. Please contact CellGate support team if the device does not operate as expected.

## Support

For assistance, call: 1 (855) 694-2837, Option 3

Additional resources can be found at: [www.cell-gate.com](http://www.cell-gate.com)

Information contained in the document is believed to be accurate and reliable at the time of printing. This document is subject to change without notice. Any updates and additional resources can be found on CellGate website at [www.cell-gate.com](http://www.cell-gate.com)