



Readers & Credentials

CR-INFINITY-HID

Quick Guide

Components

Before using the device, check the device model and ensure that the shipped box includes the following items:

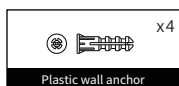
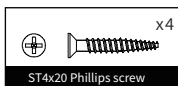
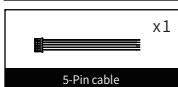
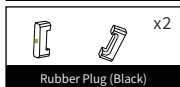
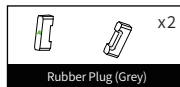
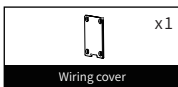

Product Overview

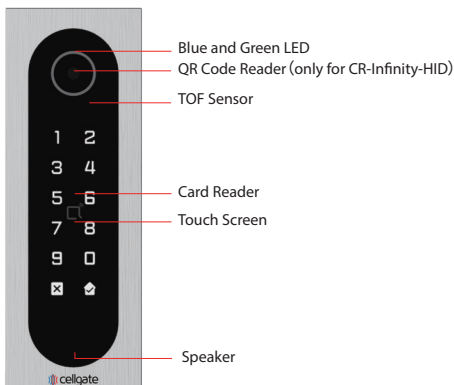

Preparation

Tools Needed

(not included)

- Phillips Screwdriver
- Electric Drill

Voltage and Current Specifications

Use 12V DC 1A power supply with 18 gauge wiring to power the device.

Installation Guidelines

- Install the device on a flat surface.
- Do not use or place the device near heaters.

Warning!

To ensure your safety, avoid touching the power cord, power adapter, and device with wet hands, bending or pulling the power cord, damaging any components, and only use the qualified power adapter and power cord.

Caution

- Do not knock device with hard objects.
- Do not press down hard on the device screen.
- Do not expose device to chemical products, such as alcohol, acid liquid, disinfectants, etc.
- To prevent the device installation from loosening, ensure accurate sizes and depths of screw holes.
- To clean the device, softly wipe with a moist cloth, then wipe with a dry cloth.

Wiring Interface

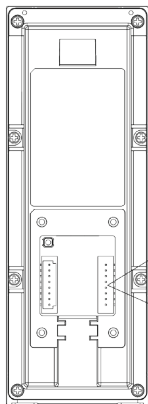

Wire Descriptions	
Red	12V DC+ Power
Black	Power Ground
Gray	Wiegand Ground
Green	Wiegand Data 0
White	Wiegand Data 1

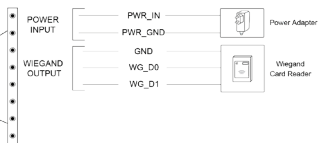

Installation

Step 1: Wall-Mounting Installation

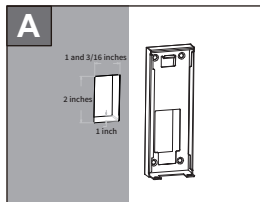

Cut a rectangular hole in the wall with dimensions 2 inches high, 1 and 3/16 inches wide, and 1 inch deep.

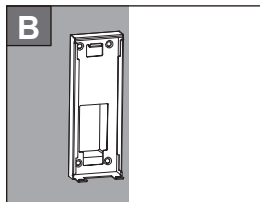

Align the rectangular hole of the wall-mounting box with the rectangular hole on the wall.

Mark the box's four holes on the wall, ensuring the marks are at the center of each hole.

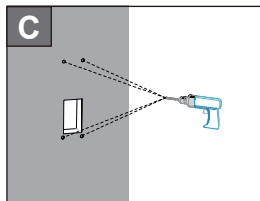

Take down the wall-mounting box.
Use a 6 mm electric drill to make four holes.

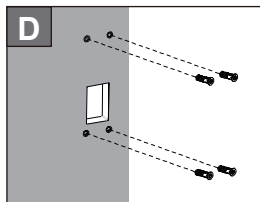

Insert four plastic wall anchors into the screw holes.

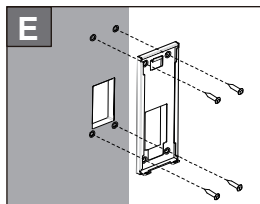

Tighten the four ST4x20 Phillips screws to the plastic wall anchors to fasten the wall-mounting box to the wall.

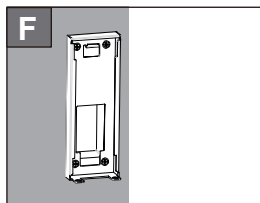

Wall-mounting installation is complete.

Note: Ensure the drilled holes are aligned with the box's holes and that the wall-mounting box is level.

Step 2: Device Mounting

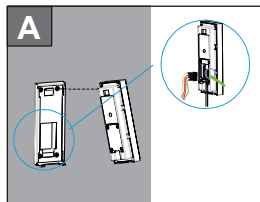

Put all wires and the Ethernet connector into the hole.

Hang the slot of the main unit into the corresponding hooks of the box, and then gently lower the main unit into the box.

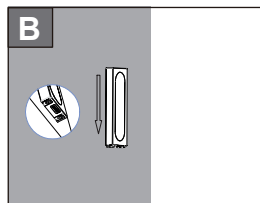

Insert the device into the wall-mounted box and lower the device onto the hook in the back and hooks projecting from the bottom of the mounting box.

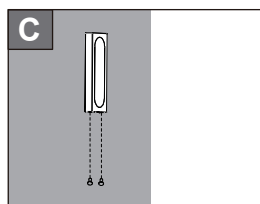

Fix two M3x6 Torx head screws into the holes.

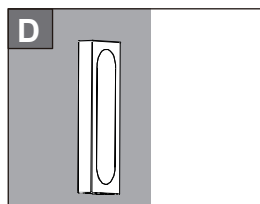

Check that the gap around the device is even, the connection is secure, and that the device can be powered on.

Installation is complete.

Warranty

CellGate does not cover intentional damage or destruction caused by improper installation. Please contact CellGate support team if the device does not operate as expected.

Support

For assistance, call: 1 (855) 694-2837, Option 3

Additional resources can be found at: www.cell-gate.com

Information contained in the document is believed to be accurate and reliable at the time of printing. This document is subject to change without notice. Any updates and additional resources can be found at www.cell-gate.com.